

## Returns

- 1 RMA is absolutely required prior to return, in order to get mailing address. Email [support@alwaysinnovating.com](mailto:support@alwaysinnovating.com)
- 2 15-day money-back guarantee applies to devices returned with all parts in **original** condition (protective plastic coverings must not have been removed). Otherwise, a minimum \$50 restocking and repackaging fee applies. Additional fees may also apply depending on the condition of the returned device.



*The magnets are very strong. Be cautious while manipulating and separating them. Don't put magnets around electronic devices that may be sensitive to magnetic field.*

## Warranties

ALWAYS INNOVATING'S RESPONSIBILITY FOR MALFUNCTIONS AND DEFECTS IN HARDWARE IS LIMITED TO REPAIR AND REPLACEMENT AS SET FORTH IN THIS WARRANTY STATEMENT. ALL EXPRESS AND IMPLIED WARRANTIES FOR THE PRODUCT, INCLUDING BUT NOT LIMITED TO ANY IMPLIED WARRANTIES AND CONDITIONS OF MERCHANTABILITY AND FITNESS FOR A PARTICULAR PURPOSE, ARE LIMITED IN TIME TO THE TERM OF THE LIMITED WARRANTY PERIOD REFLECTED ON YOUR PACKING SLIP OR INVOICE. NO WARRANTIES, WHETHER EXPRESS OR IMPLIED, WILL APPLY AFTER THE LIMITED WARRANTY PERIOD HAS EXPIRED. SOME STATES DO NOT ALLOW LIMITATIONS ON HOW LONG AN IMPLIED WARRANTY LASTS, SO THIS LIMITATION MAY NOT APPLY TO YOU.

WE DO NOT ACCEPT LIABILITY BEYOND THE REMEDIES PROVIDED FOR IN THIS LIMITED HARDWARE WARRANTY OR FOR CONSEQUENTIAL OR INCIDENTAL DAMAGES, INCLUDING, WITHOUT LIMITATION, ANY LIABILITY FOR THIRD-PARTY CLAIMS AGAINST YOU FOR DAMAGES, FOR PRODUCTS NOT BEING AVAILABLE FOR USE, OR FOR LOST DATA OR LOST SOFTWARE. OUR LIABILITY WILL BE NO MORE THAN THE AMOUNT YOU PAID FOR THE PRODUCT THAT IS THE SUBJECT OF A CLAIM. THIS IS THE MAXIMUM AMOUNT FOR WHICH WE ARE RESPONSIBLE.



[www.AlwaysInnovating.com](http://www.AlwaysInnovating.com)



Always**Innovating**

Everything you need to get you started with your new Touch Book!



## The Touch Book Getting Started Guide

For additional important information, visit

<http://wiki.alwaysinnovating.com>

For any questions, contact us at

[support@alwaysinnovating.com](mailto:support@alwaysinnovating.com)



**Software is still in beta.** Don't put any valuable or sensitive data on the Touch Book. Security is not fully guaranteed before final release. Expect bugs.



www.AlwaysInnovating.com

## Thank you for purchasing the Touch Book!

Please check to make sure you have received all the box contents

### Box Contents

- Touch Book Tablet
- Touch Book Keyboard
- 5V Power adaptor
- 3 Magnets

### 1 Power Button

Push to toggle device on/standby  
Press and hold five seconds to "hard shutdown"

### 2 Standard USB 2.0 ports

### 3 Audio line IN/OUT

### 4 AI Button

Push once for the start menu  
Push twice to show onscreen-keyboard

### 5 Tablet Locking Latches

*To detach keyboard:*  
Unlock the latches and then gently pull the tablet up and away from the keyboard.

*To attach keyboard:*  
Ensure latches on both side are in the unlocked position. Attach the tablet down onto the guide rails of the keyboard. Lock the latches.

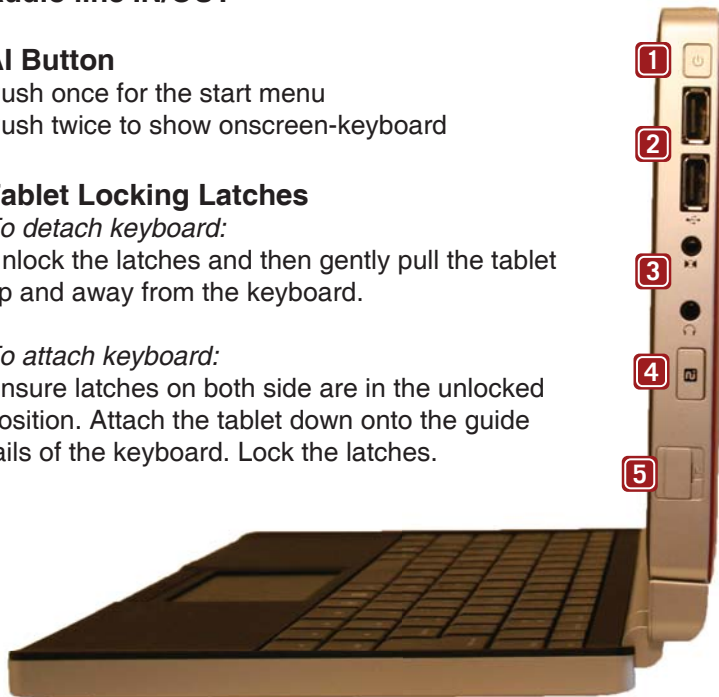

### 6 Cover Panel Locking Latch

*To open the cover panel:*  
Unlock the central latch and slide off the cover panel.

*To close the cover panel:*  
Ensure the central latch is in the unlocked position. Slide in the cover panel. Make sure that the four alignment grooves of the panel fit into the four upper alignment tabs of the tablet. Lock the central latch.

### 7 Mini USB port

### 8 5V Power Port

The Touch Book is only designed to be charged with a 5V power supply. **DO NOT CHARGE WITH A NON APPROVED POWER SUPPLY.**

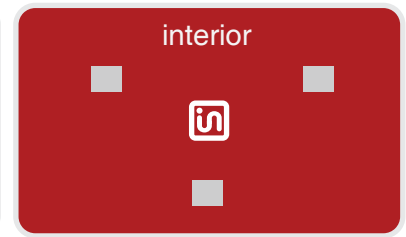

### 9 Magnets

Open the cover panel from the Touch Book before attaching the magnets to ensure proper placement. Place the three magnets **outside** with the rubber side facing the cover panel. Make sure that the magnets are centered to the three inside metal plates. Close the cover panel securely.



Your warranty does not cover any damage due to misuse or accident including but not limited to falling, dropping, water damage, and electrically overloading the device.